

Phased Array Probes

X0 Series



Features

- Quick I-PEX Connector (QX)
- Quick I-PEX Bracket
- 5m Cable
- Other cable lengths upon request

Frequent Applications

- Bore Pipe
- Small diameter tube inspection
- Fits on most low profile scanners

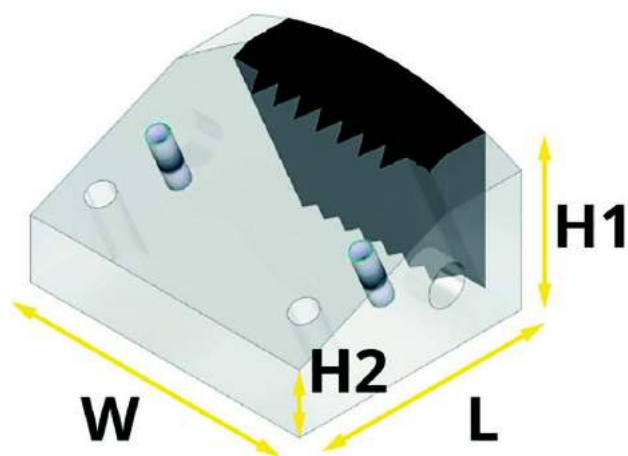

Product code	Probe Description	Frequency (MHz)	Number Elements (QTY)	Elevation E (mm)	Element Pitch P (mm)	Aperture L (mm)
X0A-001	X0A-2.25M16EFC35-0.5x10-SQX5	2.25	16	10	0.5	8
X0A-002	X0A-5M16EFC35-0.5x10-SQX5	5	16	10	0.5	8
X0A-003	X0A-7.5M16EFC35-0.5x10-SQX5	7.5	16	10	0.5	8
X0A-004	X0A-10M16EFC35-0.5x10-SQX5	10	16	10	0.5	8
X0A-005	X0A-10M32EFC35-0.25x10-SQX5	10	32	10	0.25	8

Case Dimensions (mm)		
A	B	C
26	22	9.7
26	22	9.7
26	22	9.7
26	22	9.7
26	22	9.7

Wedge	Wedge Description	Wave Type (LW/SW)	Angle Steel (°)	Cut Angle (°)	Delay Line (mm)	Length (L) (mm)	Width (W) (mm)	Front Height (H1) (mm)	Back Height (H2) (mm)
X0AW-001	X0AW-N60S-IH	S	60	39	0	18	21	13.2	2.4
X0AW-002	X0AW-N55S-IH	S	55	36	0	18	21	13.2	2.4
X0AW-003	X0AW-N45S-IH	S	45	31	0	18	21	13.2	2.4
X0AW-004	X0AW-N60L-IH	L	60	20	0	18	21	9	2.4

Phased Array Probes

X1 Series



Features

- Quick I-PEX Connector (QX)
- Quick I-PEX Bracket
- 2.5m/5m Cable
- Other cable lengths upon request

Frequent Applications

- Scribe Lines
- Automotive parts
- Machined Parts
- White Metal Sheets

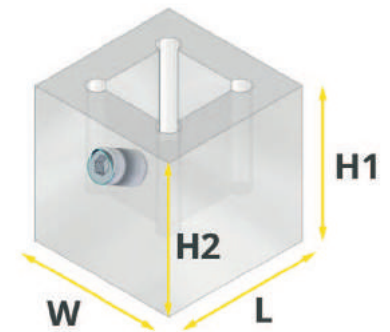
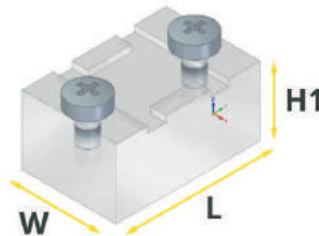
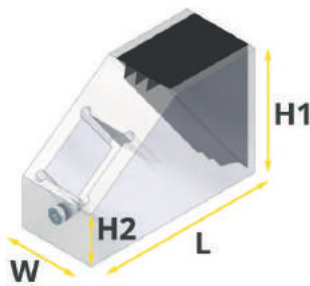

Product code	Probe Description	Frequency (MHz)	Number Elements (QTY)	Elevation E (mm)	Element Pitch P (mm)	Aperture L (mm)
2.5 Metre Cable						
X1A-001	X1A-5M10E-0.6x5-SQX2.5	5	10	5	0.6	6
X1A-002	X1A-10M10E-0.6x5-SQX2.5	10	10	5	0.6	6
X1B-001	X1B-10M16E-0.3x5-SQX2.5	10	16	5	0.3	4.8
5 Metre Cable						
X1A-003	X1A-5M10E-0.6x5-SQX5	5	10	5	0.6	6
X1A-002	X1A-10M10E-0.6x5-SQX5	10	10	5	0.6	6
X1B-001	X1B-10M16E-0.3x5-SQX5	10	16	5	0.3	4.8

Case Dimensions (mm)		
A	B	C
13	10	23
13	10	23
8	8	23
A	B	C
13	10	23
13	10	23
8	8	23

Wedge	Wedge Description	Wave Type (LW/SW)	Angle Steel (°)	Cut Angle (°)	Delay Line (mm)	Length (L) (mm)	Width (W) (mm)	Front Height (H1) (mm)	Back Height (H2) (mm)
X1AW-001	X1AW-0L10	L	0	0	10	23	15	11	11
X1AW-002	X1AW-0L20	S	55	0	20	23	15	21	21
X1AW-003	X1AW-N55S	S	55	36	0	35.5	16	24.93	12.3
X1AW-004	X1AW-N60L	L	60	20	0	29.1	16	22.6	15
X1BW-001	X1BW-0L5	L	0	0	5	15	15	15	15
X1BW-002	X1BW-0L20	L	0	0	20	15	15	30	30
X1BW-003	X1BW-N45S	S	45	31	0	23	16	16.03	8
X1BW-004	X1BW-N55S	S	55	36	0	23	16	15.39	6.8
X1BW-005	X1BW-N60S	S	60	39	0	23	16	15.36	6.8
X1BW-006	X1BW-N60L	L	60	20	0	23	16	21.43	15.9

X2 Series

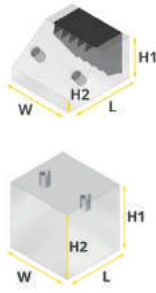

Features

- Quick I-PEX Connector (QX)
- Quick I-PEX Bracket
- 2.5m/5m Cable
- Other cable lengths upon request

Frequent Applications

- General critical welds (butt, T and corner joints)
- Castings
 - Flanges
 - Machined parts
- Automotive parts

Product code	Probe Description	Frequency (MHz)	Number Elements (QTY)	Elevation E (mm)	Element Pitch P (mm)	Aperture L (mm)
2.5 Metre Cables						
X2A-002	X2A-5M16E-0.6x10-SQX2.5	5	16	10	0.6	9.6
X2A-003	X2A-7.5M16E-0.6x10-SQX2.5	7.5	16	10	0.6	9.6
X2A-004	X2A-10M16E-0.6x10-SQX2.5	10	16	10	0.6	9.6
X2A-005	X2A-10M32E-0.3x10-SQX2.5	10	32	10	0.3	9.6
X2B-001	X2B-5M32E-0.6x10-SQX2.5	5	32	10	0.6	19.2
X2B-002	X2B-7.5M32E-0.6x10-SQX2.5	7.5	32	10	0.6	19.2
X2B-004	X2B-7.5M32E-0.6x10-SQX2.5	7.5	32	10	0.6	19.2
5 Metre Cables						
X2A-006	X2A-5M16E-0.6x10-SQX5	5	16	10	0.6	9.6
X2A-007	X2A-7.5M16E-0.6x10-SQX5	7.5	16	10	0.6	9.6
X2A-008	X2A-10M16E-0.6x10-SQX5	10	16	10	0.6	9.6
X2A-009	X2A-10M32E-0.3x10-SQX5	10	32	10	0.6	9.6
X2B-003	X2B-5M32E-0.6x10-SQX5	5	32	10	0.6	19.2

Case Dimensions (mm)		
A	B	C
16	23	20
16	23	20
16	23	20
16	23	20
16	23	20
32	23	20
32	23	20
32	23	20
32	23	20
32	23	20
32	23	20
32	23	20
32	23	20
32	23	20
32	23	20

Wedge	Description	Wave Type (LW/SW)	Angle Steel (°)	Cut Angle (°)	Delay Line (mm)	Length (L) (mm)	Width (W) (mm)	Front Height (H1) (mm)	Back Height (H2) (mm)
X2AW-001	X2AW-0L25	L	0	0	25	23	25	25	25
X2AW-002	X2AW-N45S	S	45	31	0	26.5	25	14.6	4
X2AW-003	X2AW-N55S	S	55	36	0	26.5	25	15.7	4.8
X2AW-004	X2AW-N60S	S	60	39	0	26.5	25	15.4	4
X2AW-005	X2AW-N60L	L	60	20	0	26.5	25	24	17.5
X2AW-006	X2AW-0L25-IHC	L	0	0	25	23	25	25	25
X2AW-007	X2AW-N45S-IHC	S	45	31	0	26.5	25	14.6	4
X2AW-008	X2AW-N55S-IHC	S	55	36	0	26.5	25	15.7	4.8
X2AW-009	X2AW-N60S-IHC	S	60	39	0	26.5	25	15.4	4
X2AW-010	X2AW-N60L-IHC	L	60	20	0	26.5	25	24	17.5
X2AW-101	X2AW-N60S-114COD-IHC	S	60	39	0	26.5	36.2	20	8
X2AW-102	X2AW-N60S-141COD-IHC	S	60	39	0	26.5	36.2	20	8
X2AW-103	X2AW-N60S-273COD-IHC	S	60	39	0	26.5	36.2	20	7.5
X2AW-104	X2AW-N60S-324COD-IHC	S	60	39	0	26.5	36.2	20	7.5
X2AW-105	X2AW-N60S-508COD-IHC	S	60	39	0	26.5	36.2	20	7.5
X2AW-106	X2AW-N60S-1067COD-IHC	S	60	39	0	26.5	36.2	20	7
X2BW-001	X2BW-0L25	L	0	0	25	33	25	25	25
X2BW-002	X2BW-N45S	S	45	31	0	43	25	26.8	10.6
X2BW-003	X2BW-N60S	S	60	39	0	43	25	27.4	10.6
X2BW-004	X2BW-N60L	L	60	20	0	43	25	29.2	17.4
X2BW-005	X2BW-0L25-IHC	L	0	0	25	33	36	25	25
X2BW-006	X2BW-N45S-IHC	S	45	31	0	43	36	26.8	10.6
X2BW-007	X2BW-N60S-IHC	S	60	39	0	43	36	27.4	10.6
X2BW-008	X2BW-N60L-IHC	L	60	20	0	43	36	29.2	17.4

X3 Series

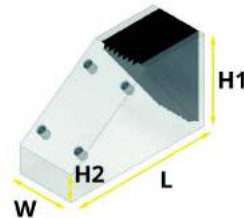
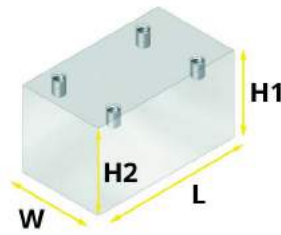

Features

- Quick I-PEX Connector (QX) Quick I-PEX Bracket
- 2.5m/5m Cable
- Other cable lengths upon request
- Immersion available on demand

Frequent Applications

- General critical welds (butt, T and corner joints)
- Castings
- Flanges
- Automotive parts
- Machined parts

Product code	Crystal Diameter (mm)	Frequency (MHz)	Number Elements (QTY)	Elevation E (mm)	Element Pitch P (mm)	Aperture L (mm)
2.5 Metre Cable						
X3A-001	X3A-2.25M48E-0.8x10-SQX2.5	2.25	48	10	0.8	38.4
X3A-002	X3A-3.5M64E-0.6x10-SQX2.5	3.5	64	10	0.6	38.4
X3A-003	X3A-5M64E-0.6x10-SQX2.5	5	64	10	0.6	38.4
X3A-004	X3A-10M64E-0.6x7-SQX2.5	10	64	7	0.6	38.4
5 Metre Cable						
X3A-005	X3A-2.25M48E-0.8x10-SQX5	2.25	48	10	0.8	38.4
X3A-006	X3A-3.5M64E-0.6x10-SQX2.5	3.5	64	10	0.6	38.4
X3A-007	X3A-5M64E-0.6x10-SQX2.5	5	64	10	0.6	38.4
X3A-008	X3A-10M64E-0.6x7-SQX2.5	10	64	7	0.6	38.4

Case Dimensions (mm)		
A	B	C
45	23	20

Wedge	Description	Wave Type (LW/SW)	Angle Steel (°)	Cut Angle (°)	Delay Line (mm)	Length (L) (mm)	Width (W) (mm)	Front Height (H1) (mm)	Back Height (H2) (mm)
X3AW-001	X3AW-0L25	L	0	0	25	45	25	25	25
X3AW-002	X3AW-N45S	S	45	31	0	65	25	41	16.7
X3AW-003	X3AW-N55S	S	55	36	0	65	25	38.6	11.7
X3AW-004	X3AW-N60S	S	60	39	0	65	25	36.3	7.5
X3AW-005	X3AW-N45L	L	45	16	0	65	25	34.4	21
X3AW-006	X3AW-N60L	L	60	20	0	65	25	43	25
X3AW-007	X3AW-0L25-IHC Wedge	L	0	0	25	45	38	25	25
X3AW-008	X3AW-N45S-IHC Wedge	S	45	31	0	65	38	41	16.7
X3AW-009	X3AW-N55S-IHC Wedge	S	55	36	0	65	38	38.6	11.7
X3AW-010	X3AW-N60S-IHC Wedge	S	60	39	0	65	38	36.3	7.5
X3AW-011	X3AW-N45L-IHC Wedge	L	45	16	0	65	38	34.4	2.1
X3AW-012	X3AW-N60L-IHC Wedge	L	60	20	0	65	38	43	25
X3AG-001	X3AG-0LW25	L	0	0	25	66	34.1	25	25
X3AG-002	X3AG-0LW6.35	L	0	0	6.35	*	*	*	*

*Dimensions available upon request

X4 Series

Features

- Quick I-PEX Connector (QX).
- Quick I-PEX Bracket.
- 2.5m/5m Cable.
- Other cable lengths upon request.

Frequent Applications

- General critical welds (butt, T and corner joints)
- Castings
- Flanges
- Automotive parts
- Machined parts



Product code	Probe Description	Frequency (MHz)	Number Elements (QTY)	Elevation E (mm)	Element Pitch P (mm)	Aperture L (mm)
2.5 Metre Cable						
X4Z-001	X4Z-2M8E-N50S-1x9-SQX2.5	2	8	9	1	8
X4Z-002	X4Z-4M16E-N50S-0.5x9-SQX2.5	4	16	9	0.5	8
5 Metre Cable						
X4Z-003	X4Z-2M8E-N50S-1x9-SQX5	2	8	9	1	8
X4Z-004	X4Z-4M16E-N50S-0.5x9-SQX5	4	16	9	0.5	8

Case Dimensions (mm)		
A	B	C
27	16.5	22
27	16.5	22
A	B	C
27	16.5	22
27	16.5	22

X6 Series

Features

- Quick I-PEX Connector (QX).
- Quick I-PEX Bracket.
- 2.5m/5m Cable.
- Other cable lengths upon request.

Frequent Applications

- Aerospace parts
- Large Aluminium plates (delaminations)
- Corrosion, blistering and thickness mapping

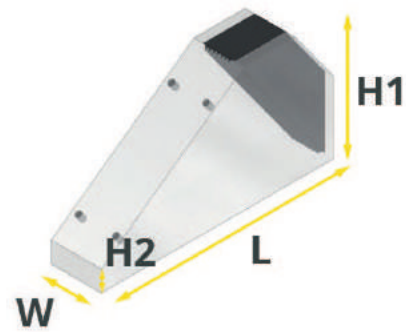

Product code	Probe Description	Frequency (MHz)	Number Elements (QTY)	Elevation E (mm)	Element Pitch P (mm)	Aperture L (mm)
2.5 Metre Cables						
X6A-001	X6A-3.5M128E-0.75x10-SQX2.5	3.5	128	10	0.75	96
X6A-002	X6A-5M128E-0.75x10-SQX2.5	5	128	10	0.75	96
5 Metre Cable						
X6A-003	X6A-3.5M128E-0.75x10-SQX5	3.5	128	10	0.75	96
X6A-004	X6A-5M128E-0.75x10-SQX5	5	128	10	0.75	96

Case Dimensions (mm)		
A	B	C
56	28	27.5
60	28	27.5
A	B	C
56	28	27.5
60	28	27.5

Product code	Probe Description	Frequency (MHz)	Number Elements (QTY)	Elevation E (mm)	Element Pitch P (mm)	Aperture L (mm)
2.5 Metre Cables						
X6A-001	X6A-3.5M128E-0.75x10-SQX2.5	3.5	128	10	0.75	96
X6A-002	X6A-5M128E-0.75x10-SQX2.5	5	128	10	0.75	96
5 Metre Cable						
X6A-003	X6A-3.5M128E-0.75x10-SQX5	3.5	128	10	0.75	96
X6A-004	X6A-5M128E-0.75x10-SQX5	5	128	10	0.75	96

Case Dimensions (mm)		
A	B	C
56	28	27.5
60	28	27.5
A	B	C
56	28	27.5
60	28	27.5

Phased Array Probes

X5 Series

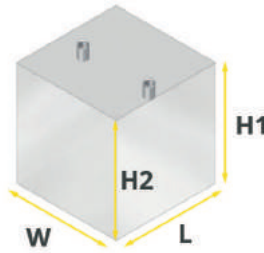
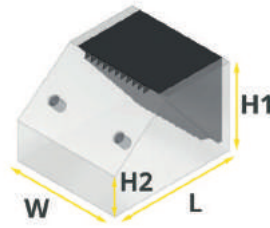

Features

- Quick I-PEX Connector (QX)
- Quick I-PEX Bracket
- 2.5m/5m Cable
- Other cable lengths upon request

Frequent Applications

- Structural component (large pins)
- Shaft
- Casting, bars and billets
- Critical large weld inspection

Product code	Probe Description	Frequency (MHz)	Number Elements (QTY)	Elevation E (mm)	Element Pitch P (mm)	Aperture L (mm)
2.5 Metre Cable						
X5A-001	X5A-2.25M16E-1x16-SQX2.5	2.25	16	16	1	16
X5A-002	X5A-5M16E-1x16-SQX2.5	5	16	16	1	16
X5A-003	X5A-2.25M16EHF-1x16-SQX2.5	2.25	16 (Hard-Face)	16	1	16
X5A-004	X5A-5M16EHF-1x16-SQX2.5	5	16 (Hard-Face)	16	1	16
5 Metre Cable						
X5A-005	X5A-2.25M16E-1x16-SQX5	2.25	16	16	1	16
X5A-006	X5A-5M16E-1x16-SQX5	5	16	16	1	16
X5A-007	X5A-2.25M16EHF-1x16-SQX5	2.25	16 (Hard-Face)	16	1	16
X5A-008	X5A-5M16EHF-1x16-SQX5	5	16 (Hard-Face)	16	1	16

Case Dimensions (mm)		
A	B	C
23	45	20
23	45	20
23	45	20
23	45	20
A	B	C
23	45	20
23	45	20
23	45	20
23	45	20

Wedge	Description	Wave Type (LW/SW)	Angle Steel (°)	Cut Angle (°)	Delay Line (mm) (mm)	Length (L) (mm)	Width (W) (mm)	Front Height (H1) (mm)	Back Height (H2) (mm)
X5AW-001	X5AW-0L40 L	L	0	0	40	38	38	40	40
X5AW-002	X5AW-N60S	S	60	39	0	45	38	30.2	13.6
X5AW-003	X5AW-N60L	L	60	20	0	45	38	33	21
X5AW-004	X5AW-0L40 L-IHC	L	0	0	40	38	49	40	40
X5AW-005	X5AW-N60S-IHC	S	60	39	0	45	49	30.2	13.6
X5AW-006	X5AW-N60L-IHC	L	60	20	0	45	49	33	21